



2017 •

## 管道跨越桥模型制作与测试

1600

20



1

400mm

500mm

1200mm

2



2017 •

- 1. 1200mm 400mm
- 500mm
- 2.
- 3.
- 4. 10
- 5.
- 6.
- 7. 6Kg 120\*60\*106mm 4Kg 120\*60\*70.6mm 3Kg
- 120\*60\*53mm 3
- 8. 500mm 500mm 100mm
- 4.

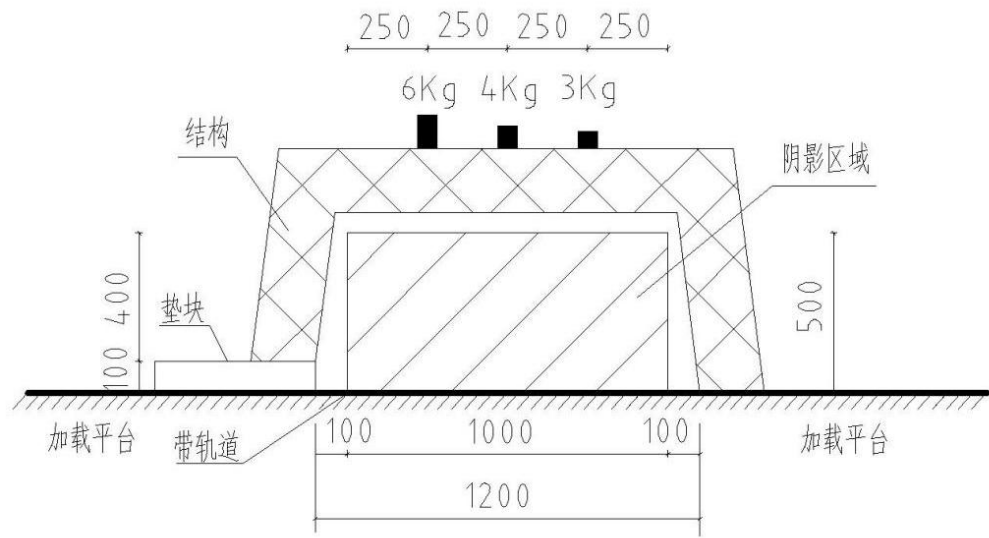

2



2017 •

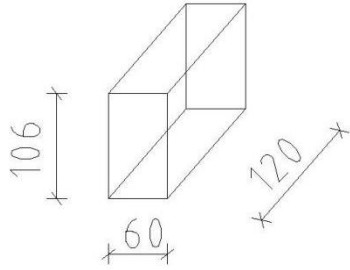

6Kg配重尺寸

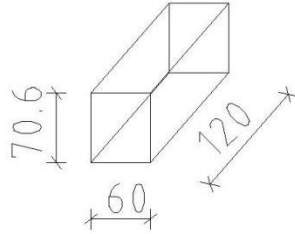

4Kg配重尺寸

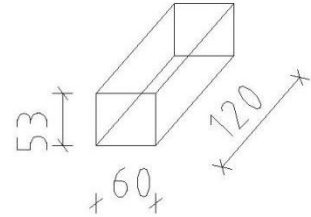

3Kg配重尺寸

3

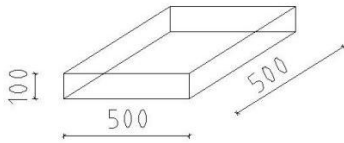

垫块尺寸图

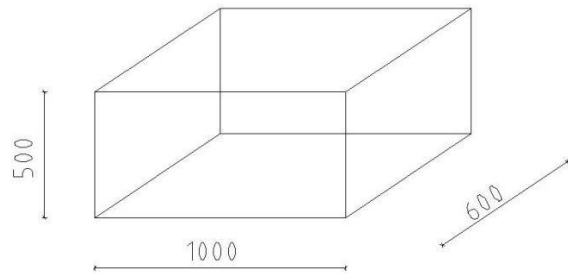

箱子尺寸图

4

1.

2.

2

5  
10s

3.

600mm

500mm

4

2

5

3

6Kg 4Kg 3Kg

1000mm



2017 •

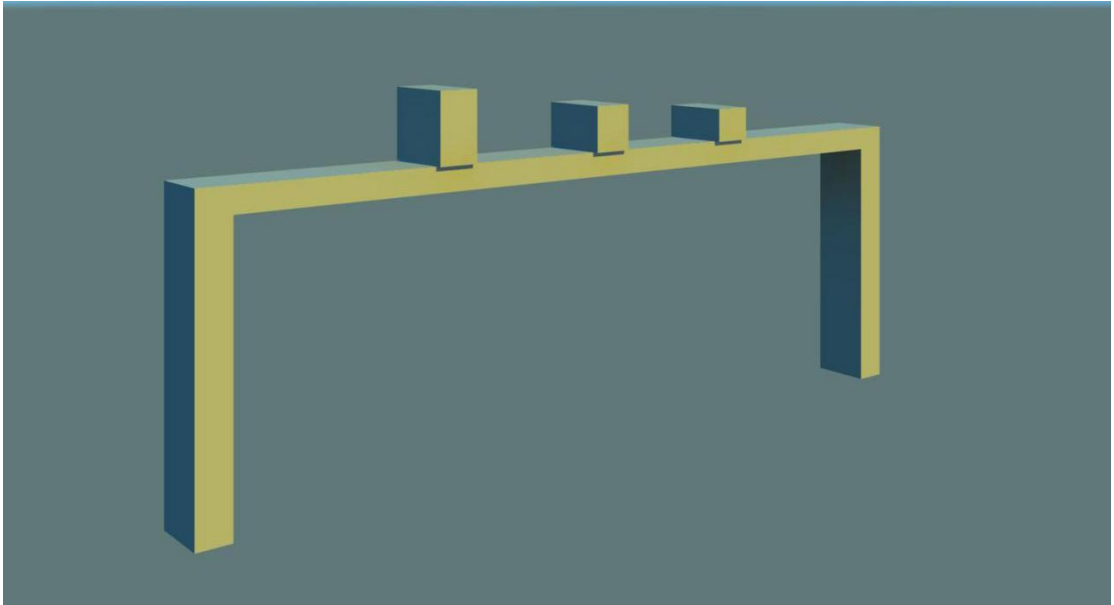

5

- 1.
- 2.
- 3.
- 4.

- 1.
- 2.
- 3.

1



2

1

	mm	g/
	1250×430×0.2	70
	1250×430×0.35	123
	1250×430×0.5	175
	900×2×2	2.5
	900×3×3	5.6
	900×1×6	3.8

2

	0.8g/cm <sup>3</sup>
	60MPa
	30MPa
	6GPa

502

- 1.
- 2.
- 3.

M

- 1.
- 2.
- 3.

1min

10s 10s



	100	
	10%	10
10%		10
80%		80
5min		
2		

$$F_1 (10)$$

( 6 )

( 4 )

$$F_2 (10)$$

( 10 )

$$F_3 (80)$$

1.

$$F_3^1 = \frac{M_{\min}}{M_1} * 80 * 50\%$$

$M_{\min}$  加载成功队伍模型质量最小值（且通过净空检测）

$M_1$  加载成功队伍模型质量

2.

$$F_3^2 = \frac{M_{\min}}{M_1} * 80 * 50\%$$

$$F_4$$

**F**

$$F \quad F_1 \quad F_2 \quad F_3^1 \quad F_3^2 \quad F_4$$

1. 3-5

2.

3.

4.



2017 •

	(mm)	
		10 /
		22 /
		27 /
	900	0.55 /
	900	0.75 /
	900 1 6	1 /

13082806354

310